

JAEGER

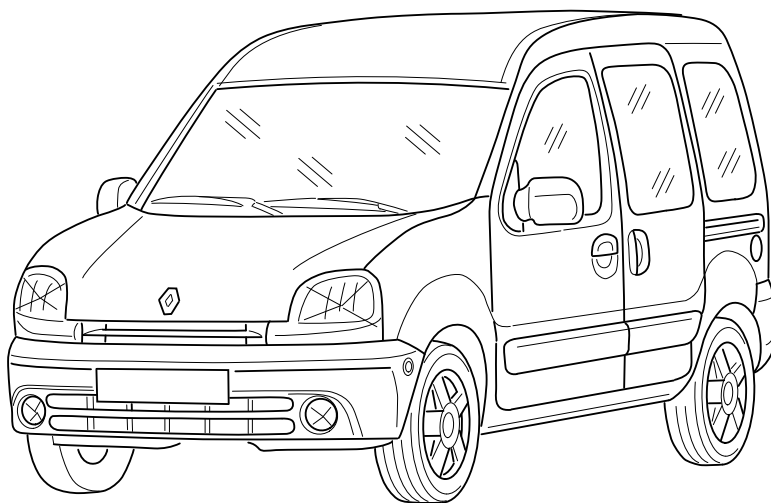

RENAULT KANGOO 1 Ph 1+2 04/98 >> 12/07

Ohne Überwachung der Anhänger-Blinkleuchten!

Without monitoring of the trailer turn signals!

735008

745008

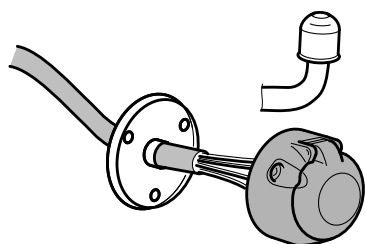

7-PIN

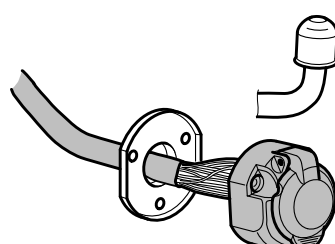
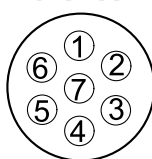

13-PIN

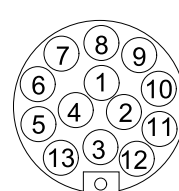

- (D)** Einbauanleitung
- (GB)** Fitting instructions
- (F)** Instructions de montage
- (E)** Instrucciones de montaje
- (NL)** Inbouwhandleiding
- (P)** Instruções de montagem
- (I)** Istruzioni di montaggio

- (CZ)** Pokyny pro montáž
- (H)** Felszerelési utasítás
- (PL)** Instrukcje wbudowania
- (GR)** Οδηγίες συναρμολόγησης
- (S)** Montageanvisning
- (SLO)** Navodila za instalacijo
- (TR)** Montaj talimatları

FRICH

735008

KIT

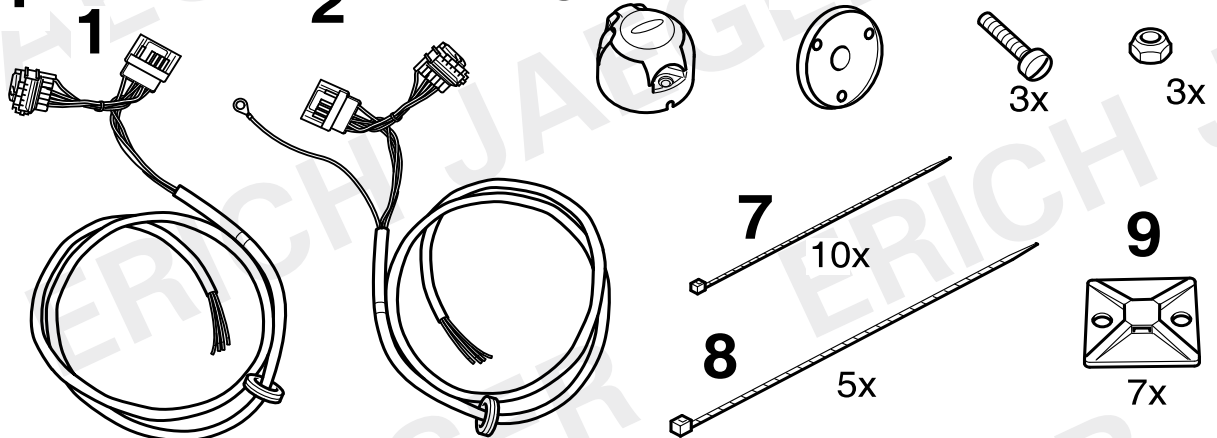

745008

KIT

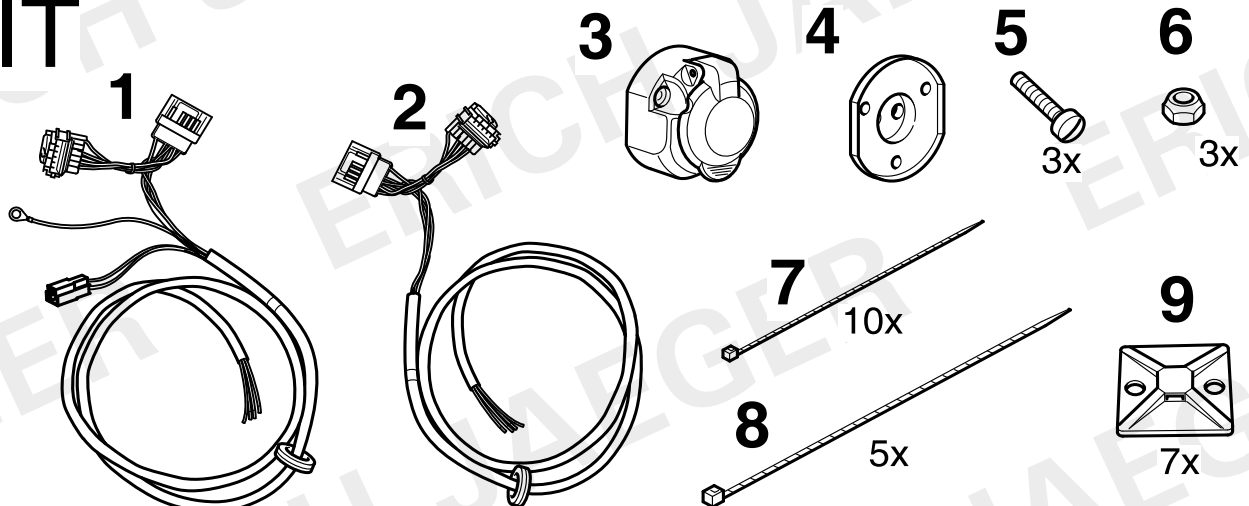

Tools

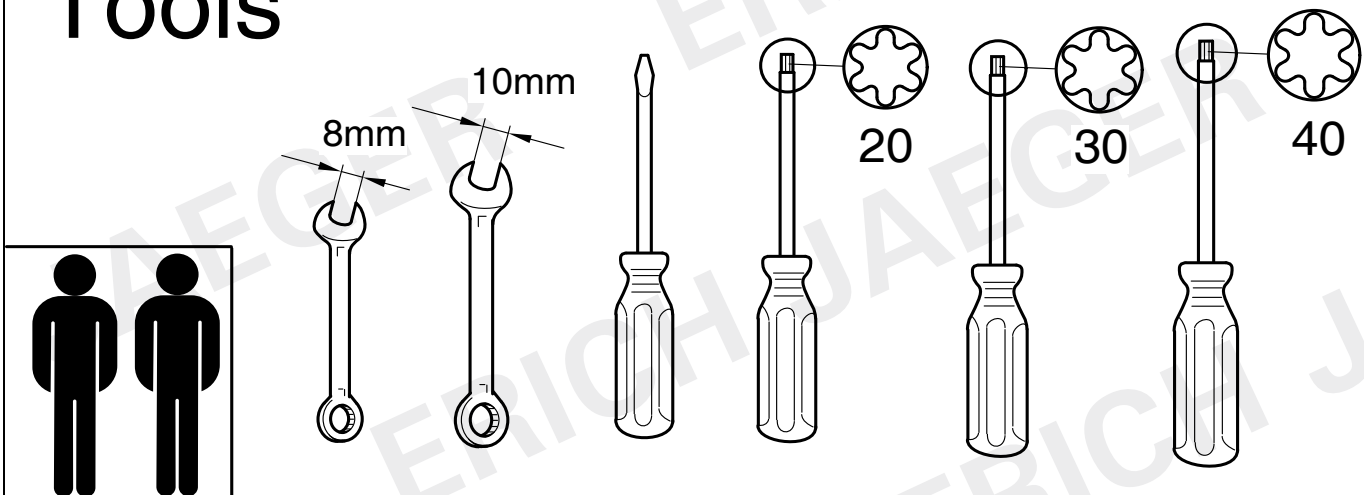

1

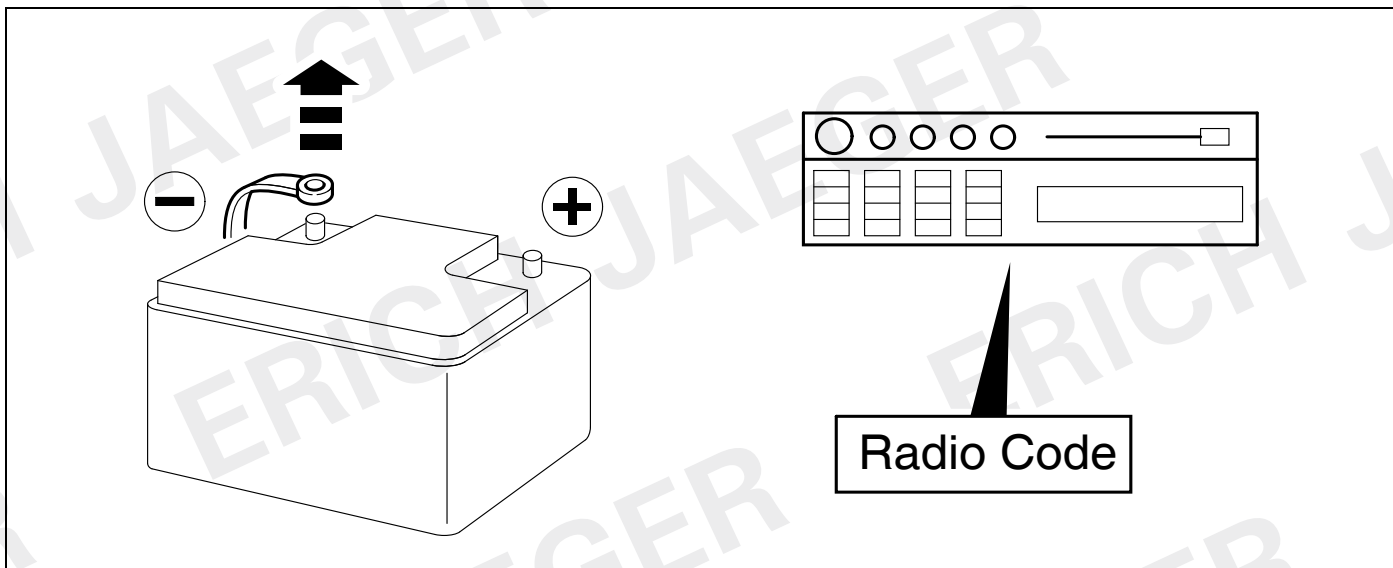

2

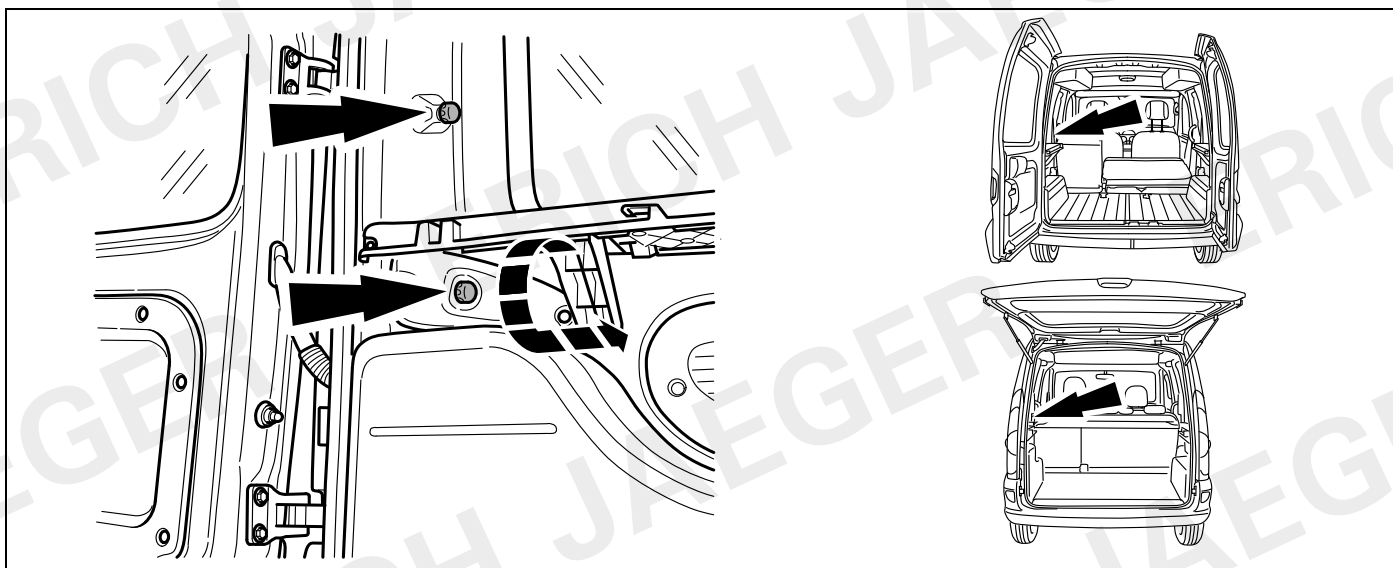

3

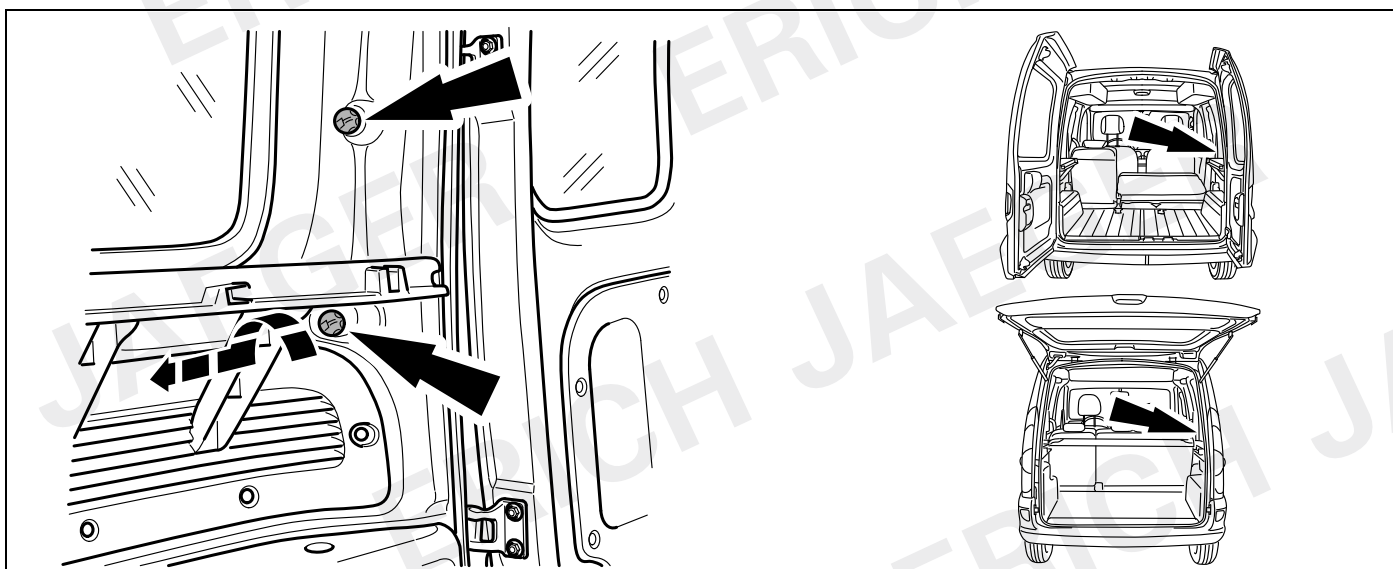

4

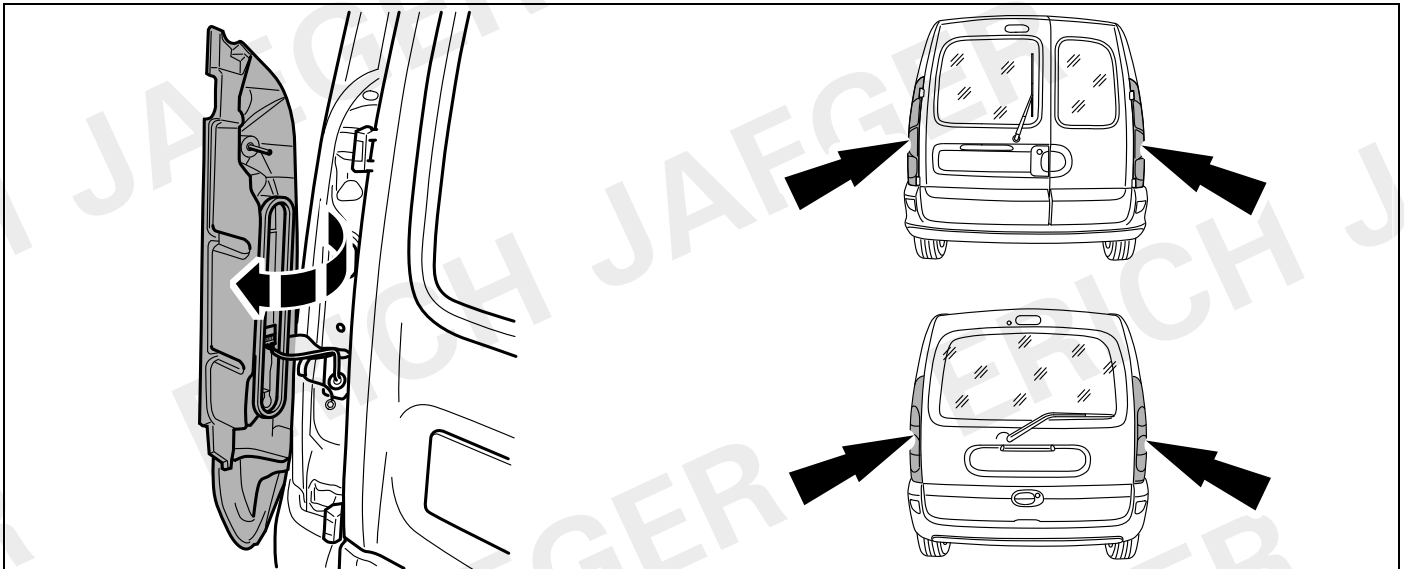

5

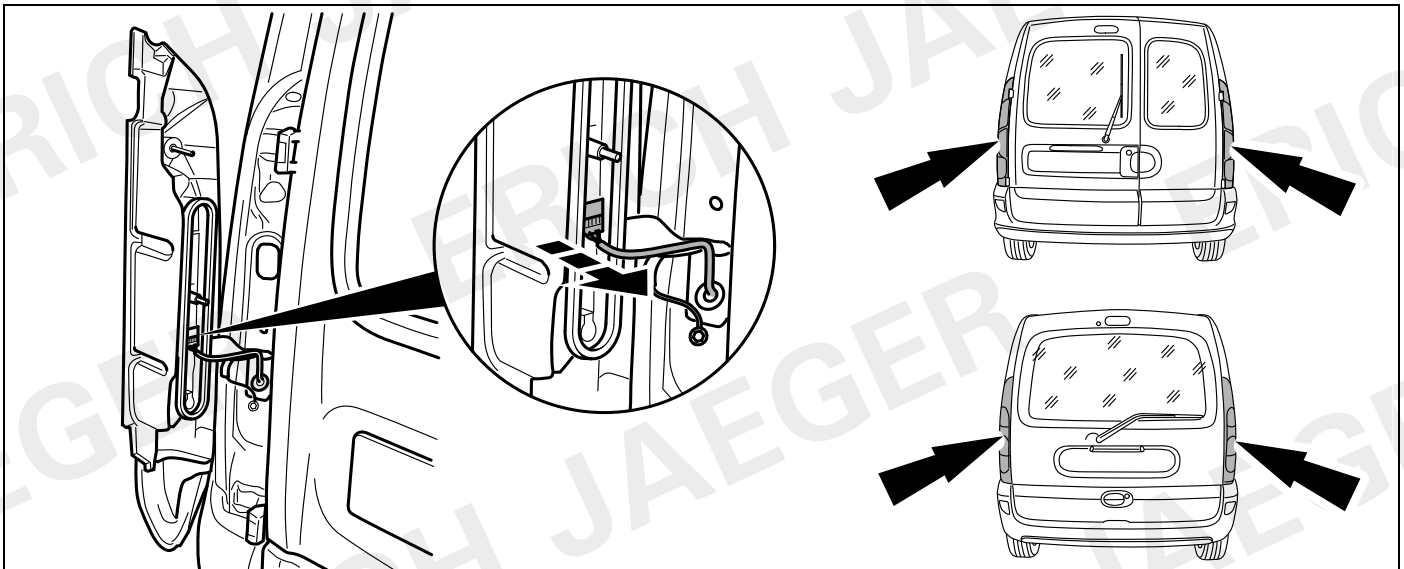

6

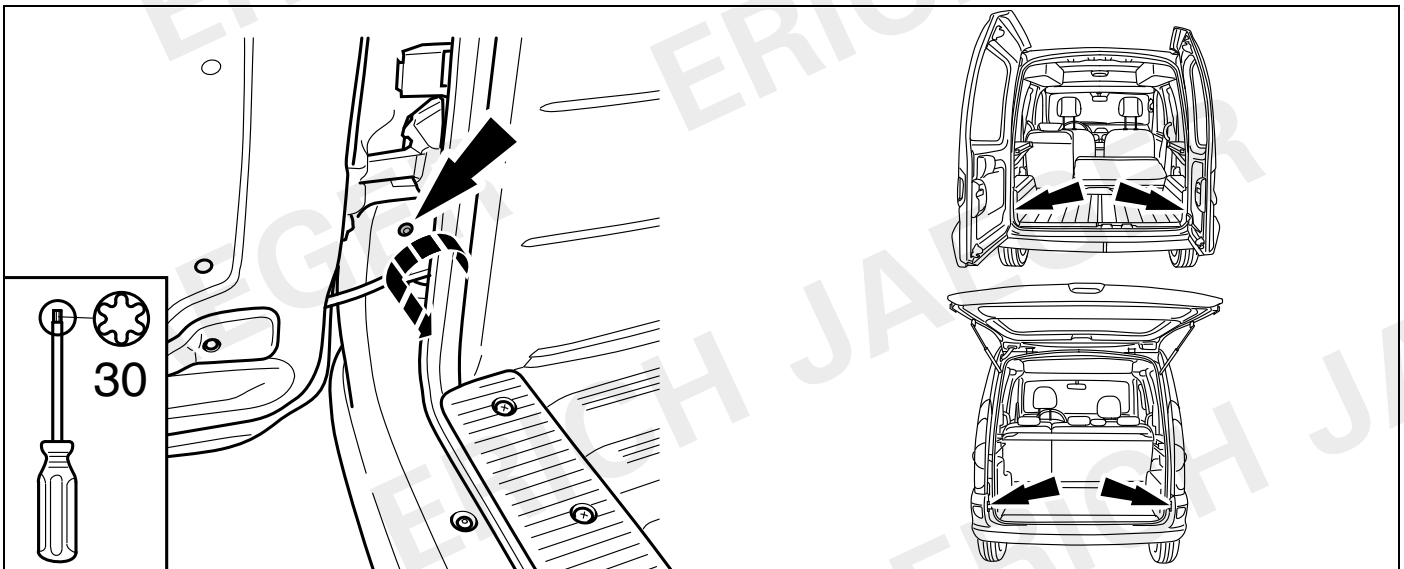

7

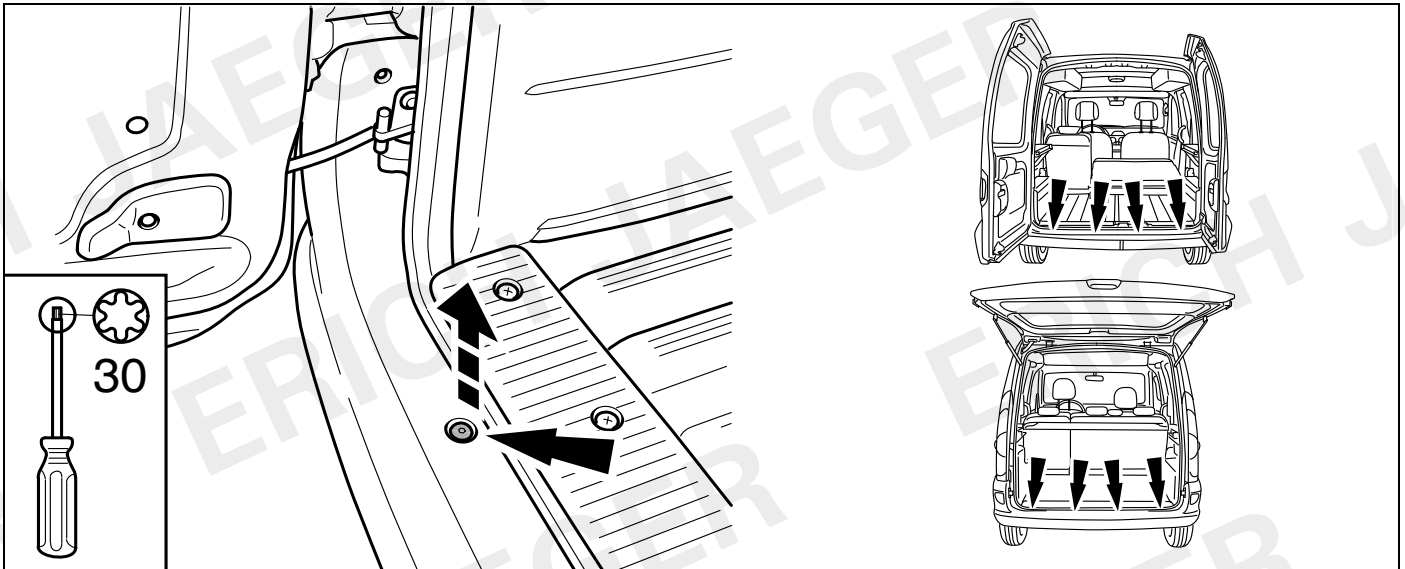

8

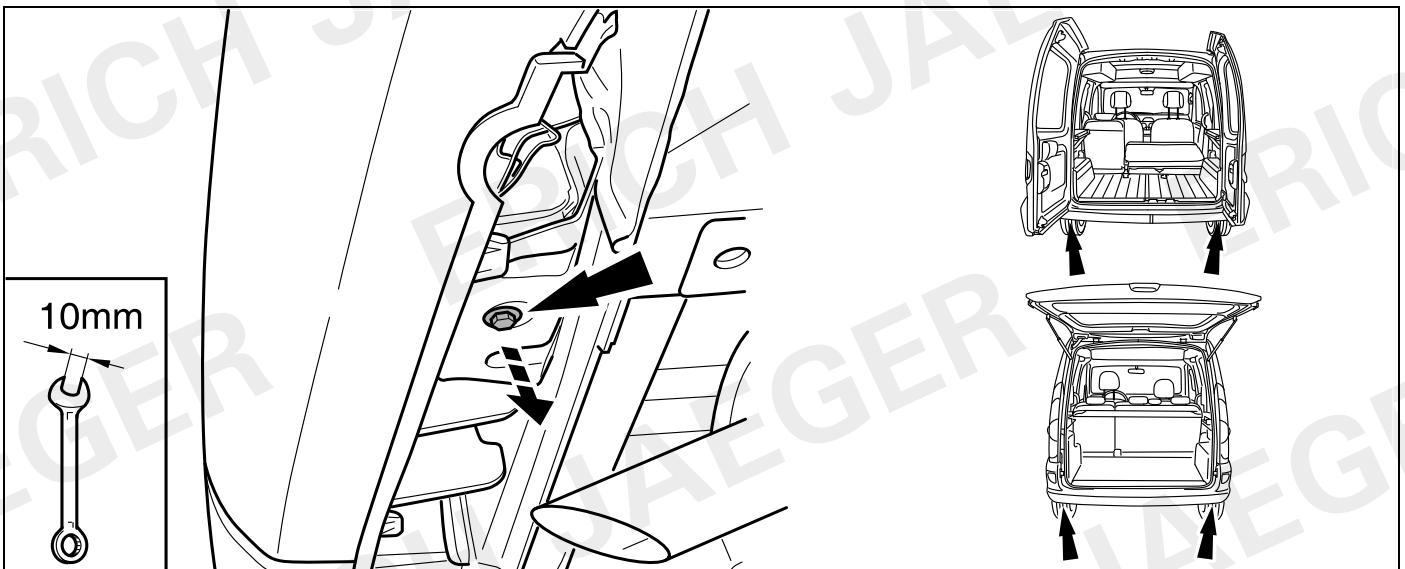

9

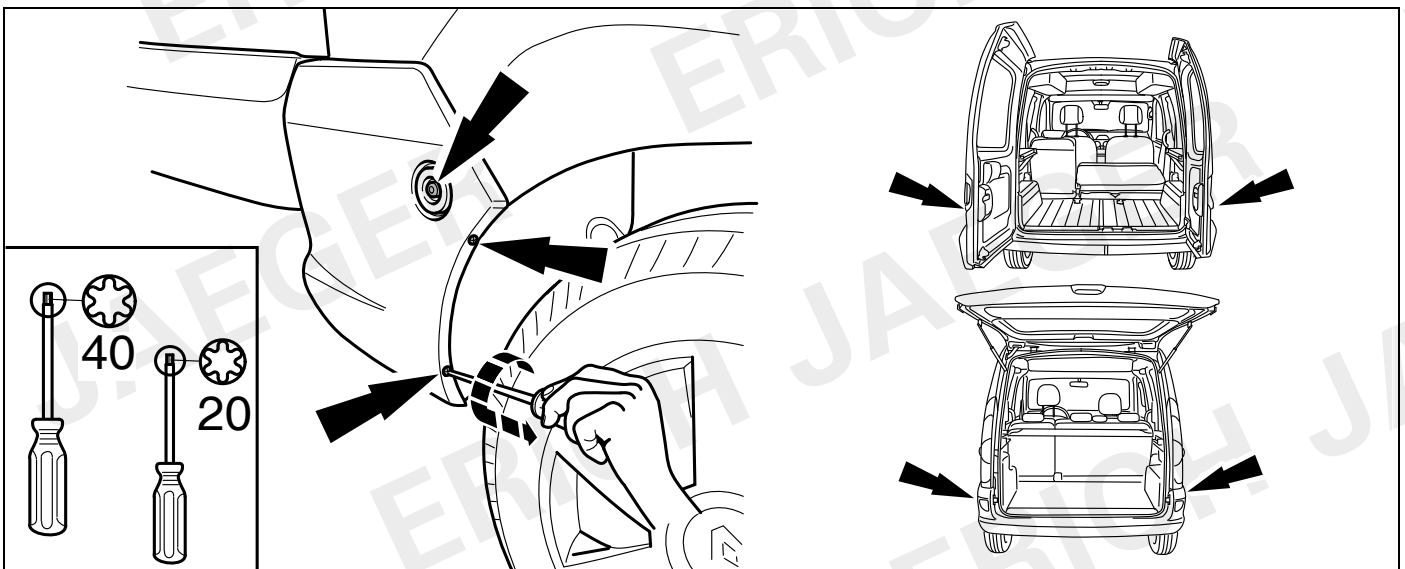

10

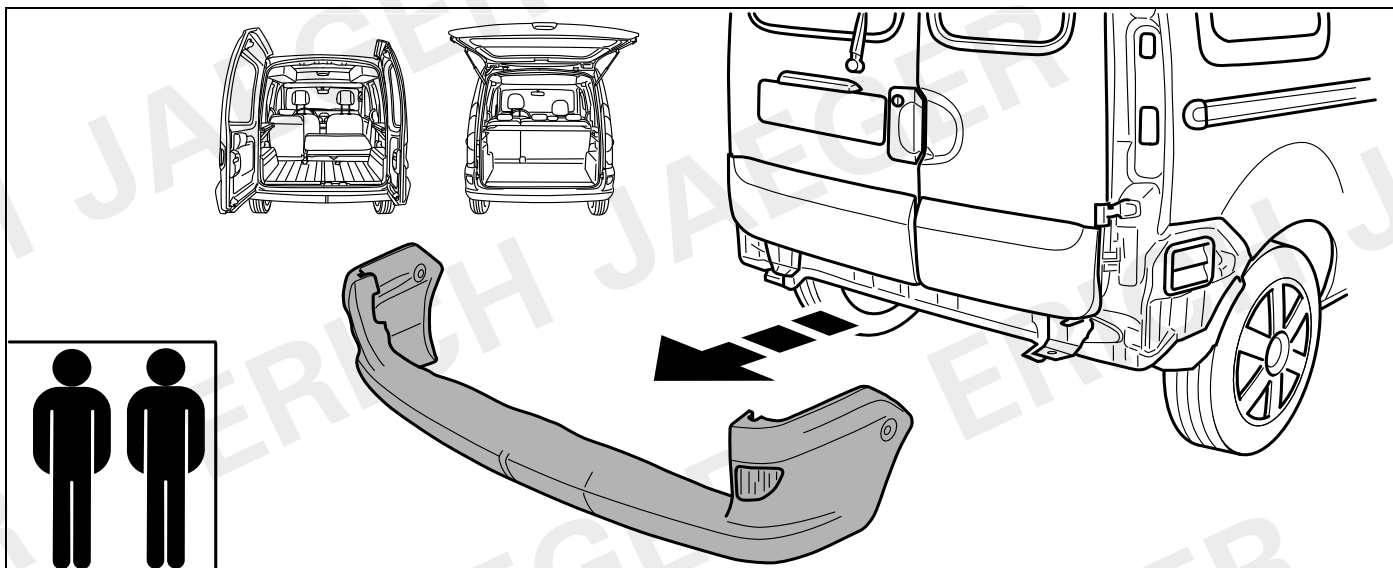

11

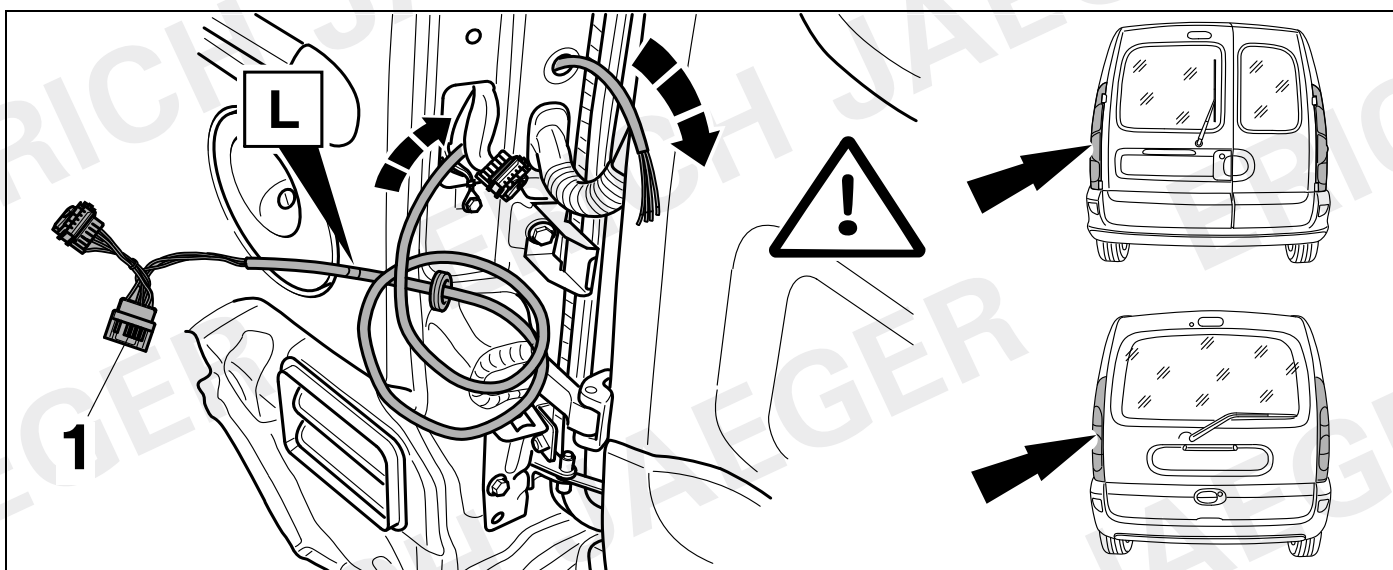

12

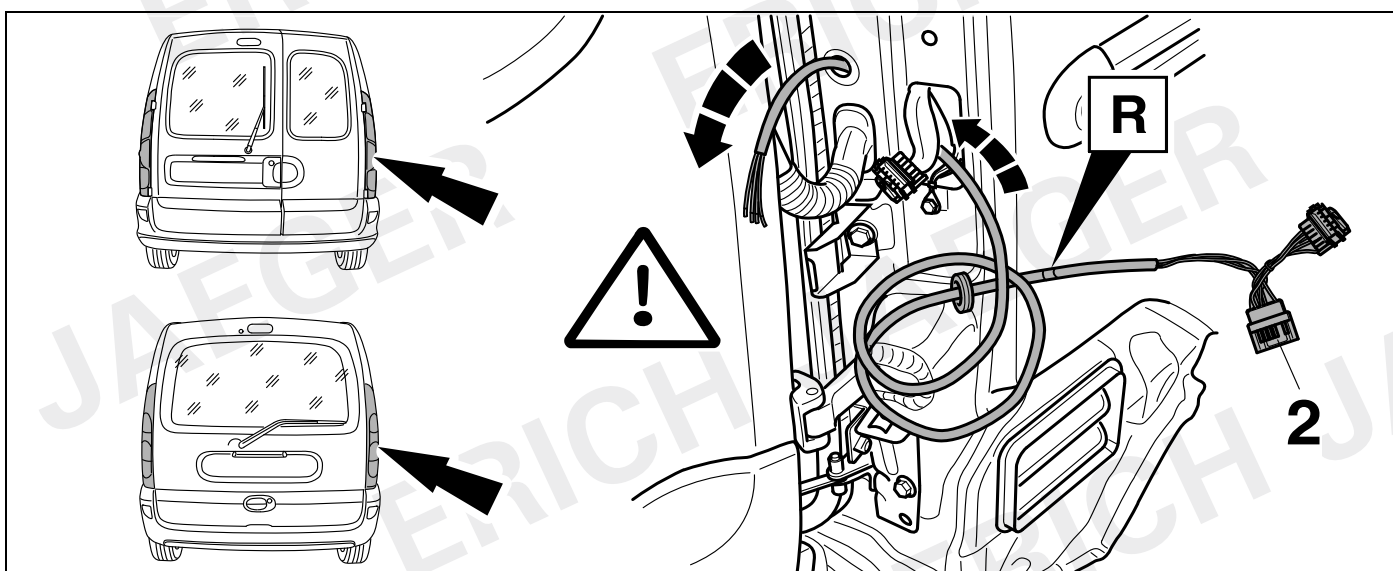

13

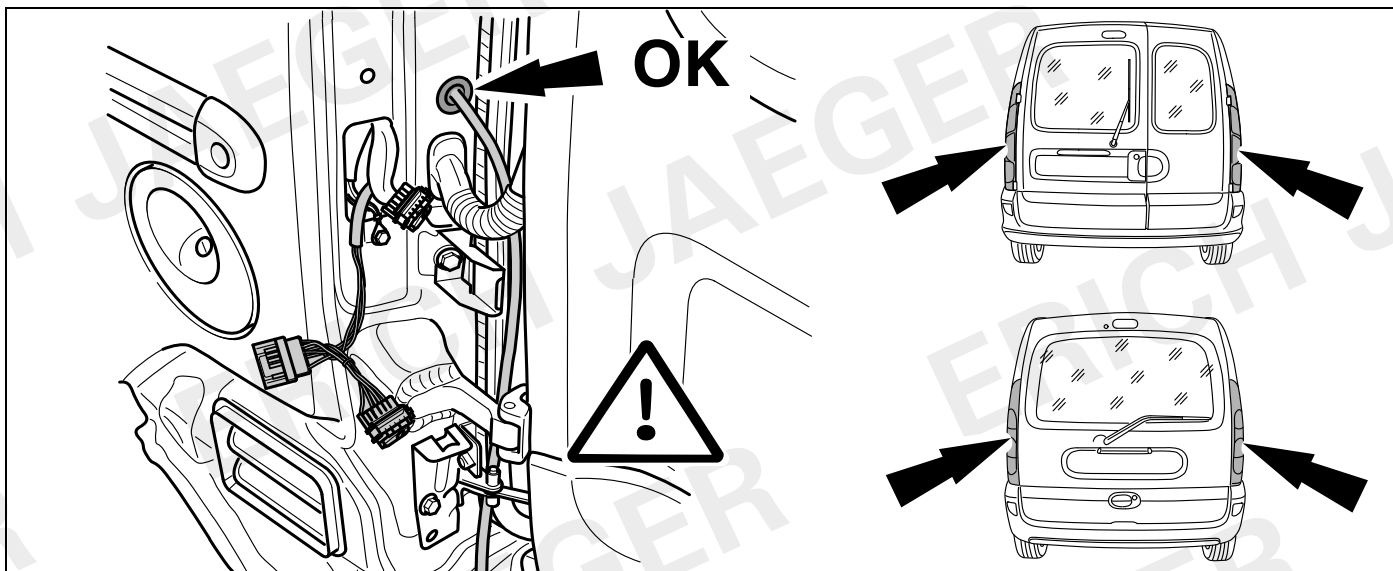

14

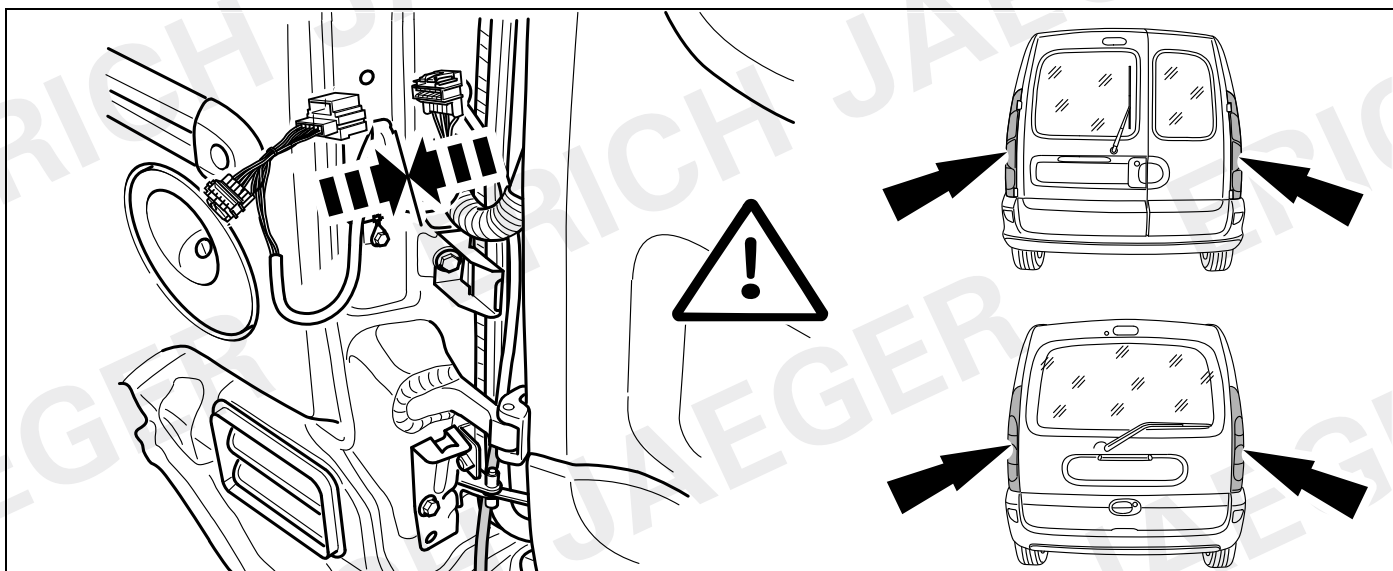

15

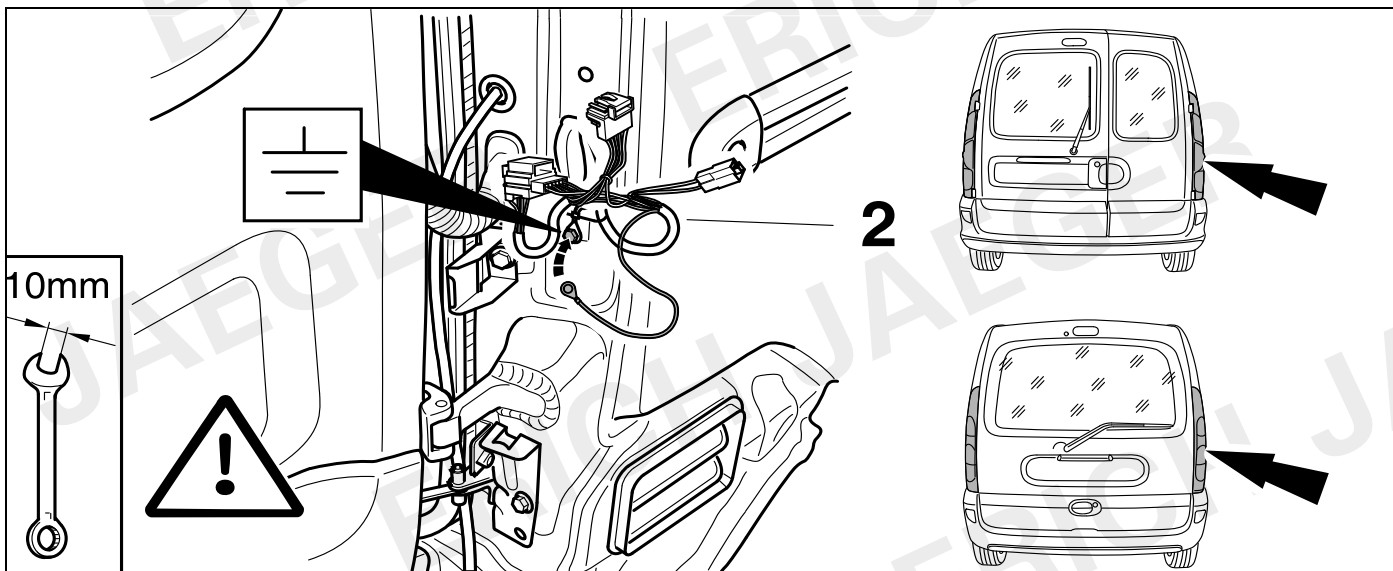

16

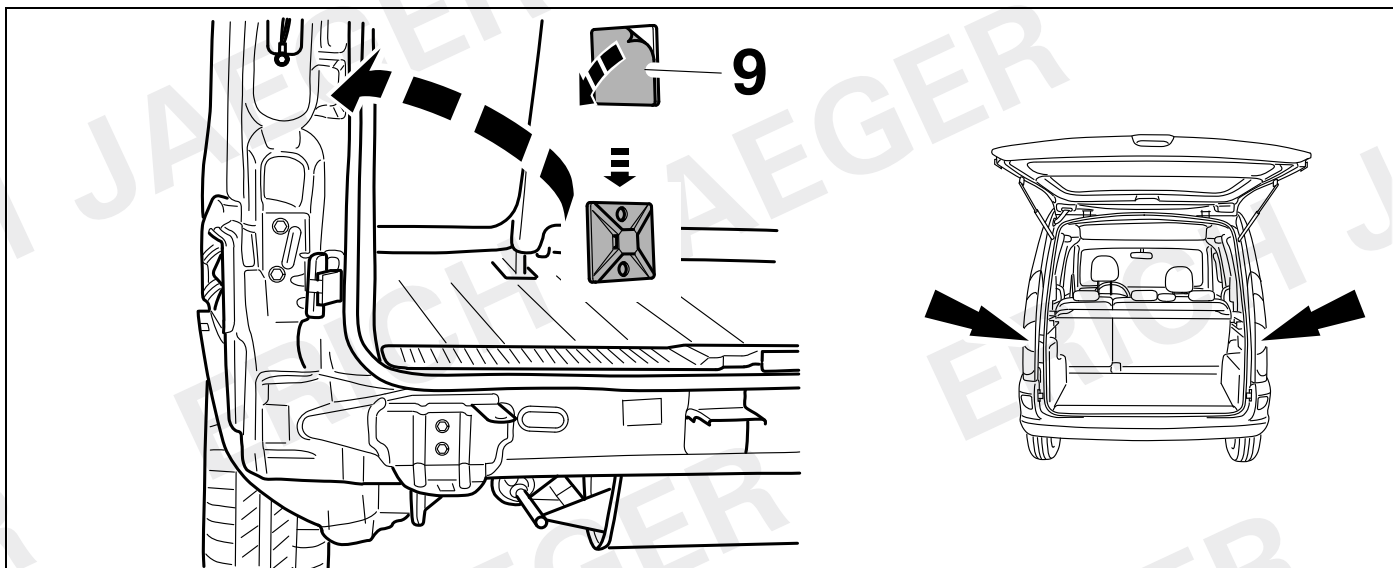

17

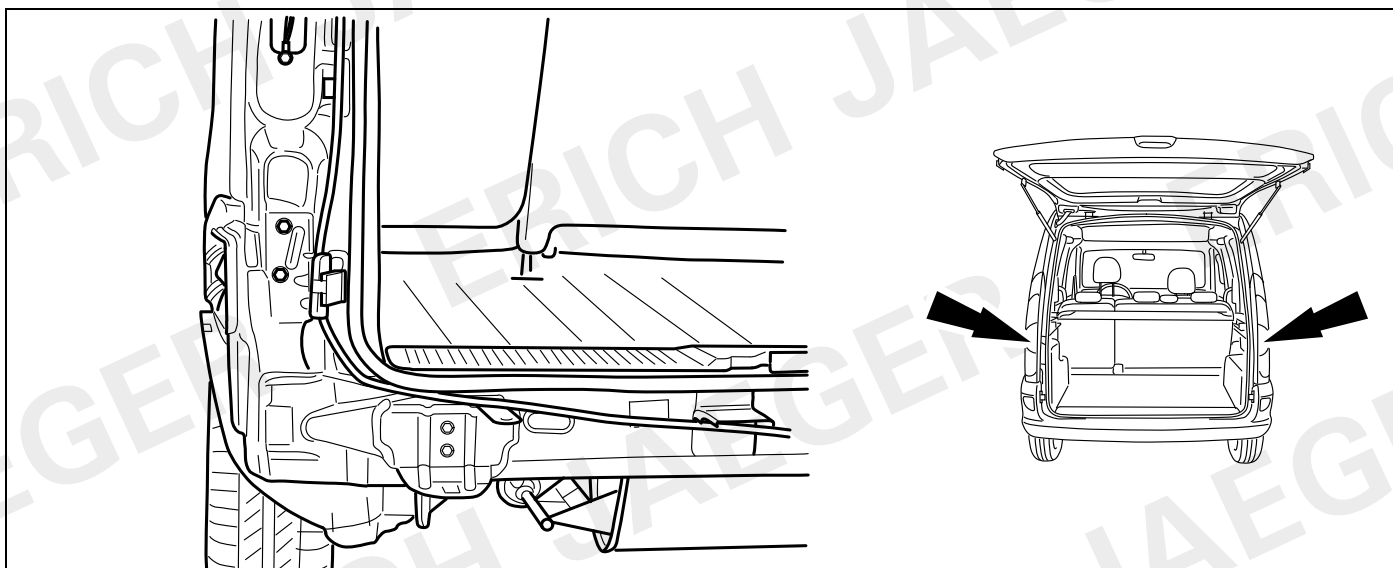

18

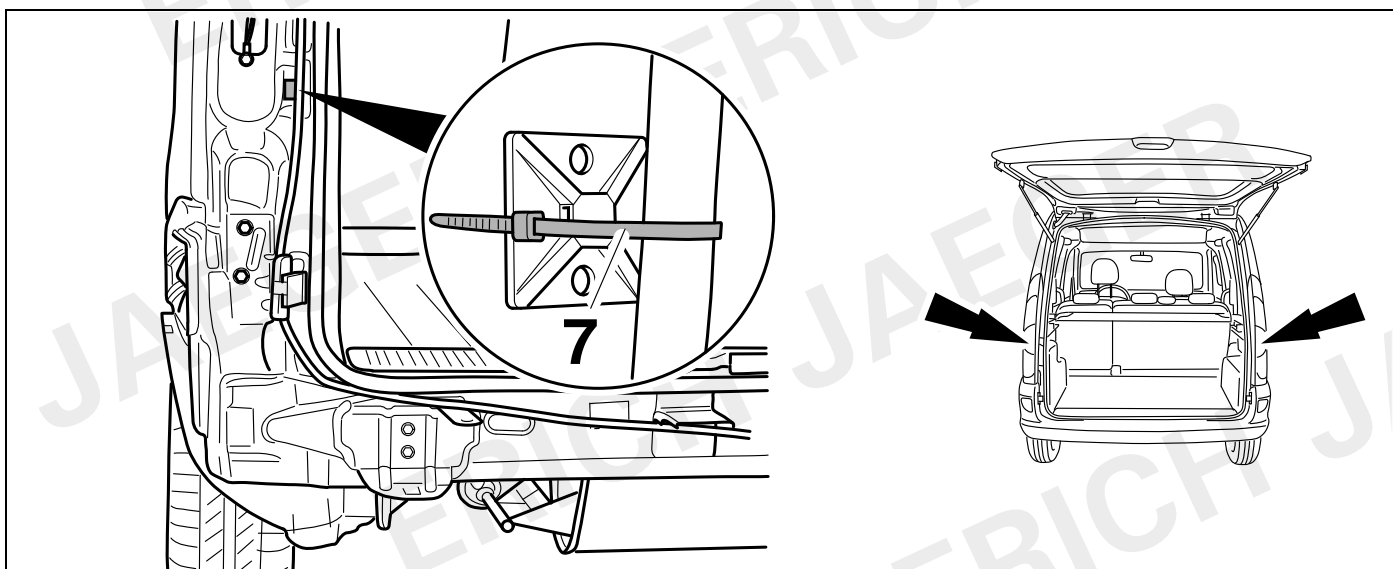

19

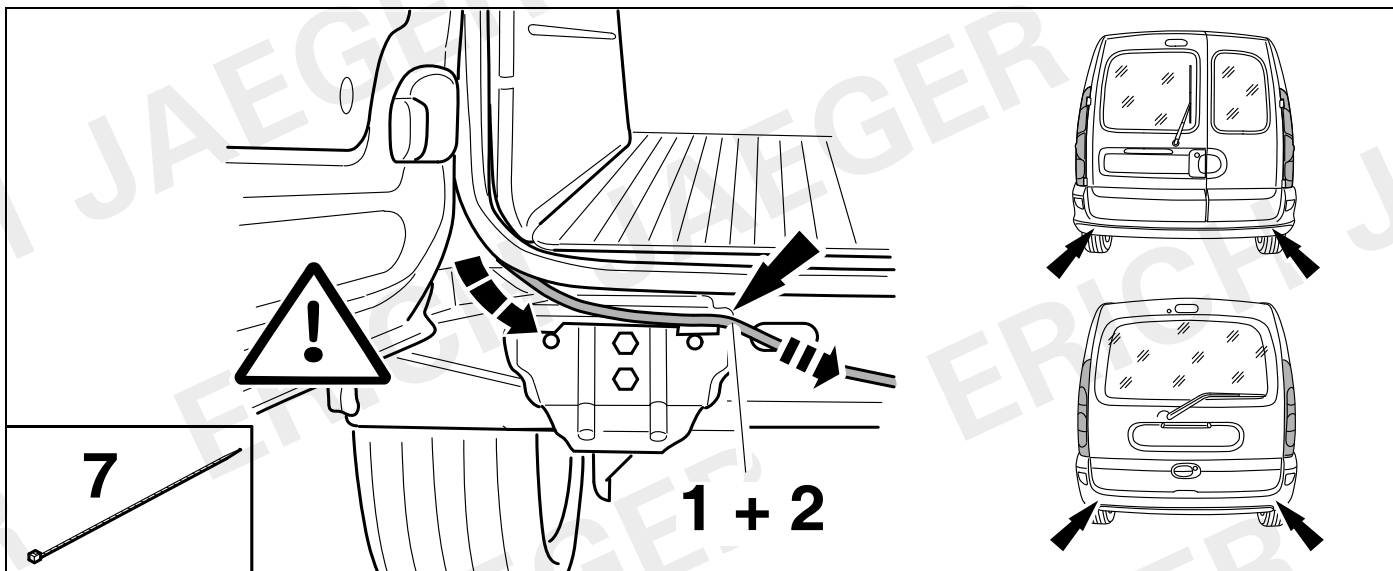

20

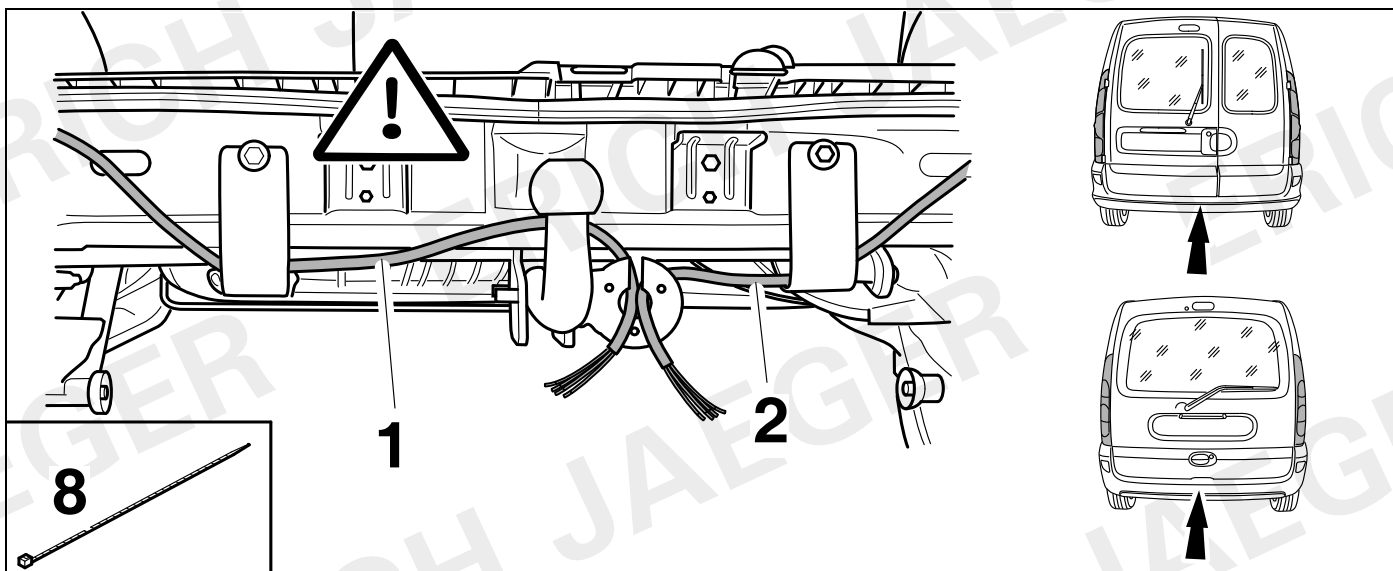

21

735008

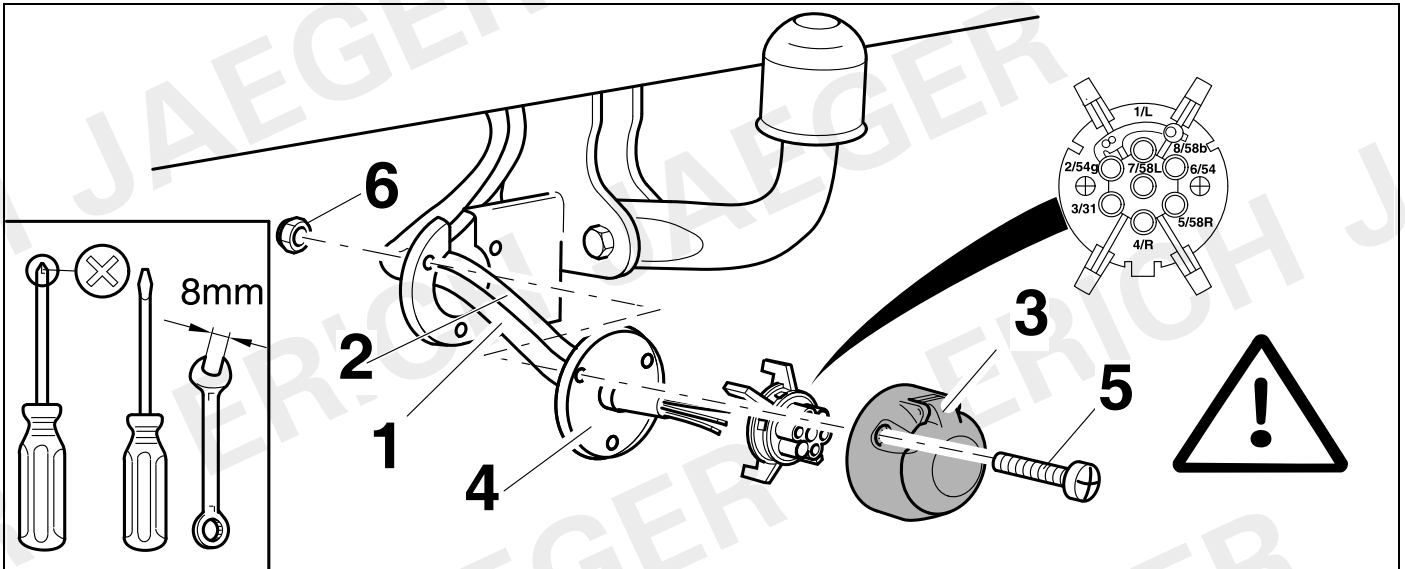





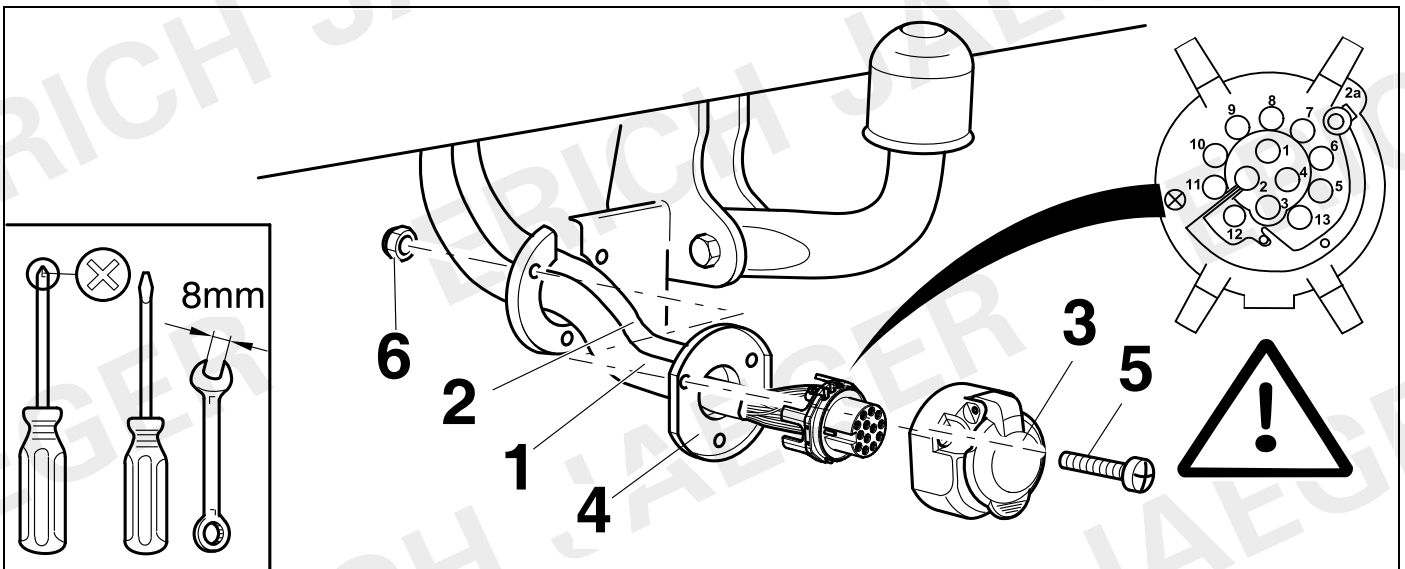





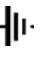

22

745008

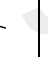
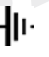

23	735008 / 745008	745008
----	-----------------	--------

	D	GB	F	E	NL	P	I	CZ	H	PL	GR	S	SLO	TR
1		black/white	noir/blanc	negro/blanco	zwart/wit	preto/branco	nero/bianco	černo/bílý	fekete/fehér	czarno/biały	μαύρο/λευκό	svart/vit	črna/bela	siyah/beyaz
2		grey	gris	gris	grijs	cinzento	grigio	šedý	szürke	szary	Γκρι	grå	siva	gri
3		white/brown	blanc/brun	blanco/marrón	wit/bruin	branco/castanho	bianco/marrone	bílo/hnědo	fehér/barna	biało/brązowo	λευκό/καφέ	vit/brun	bela/smeđa	beyaz/kahverengi
4		black/green	noir/vert	negro/verde	zwart/groen	preto/verde	nero/verde	černo/zelený	fekete/zöld	czarno/zielony	μαύρο/πράσινο	svart/grön	črna/zelena	siyah/yeşil
5		grey/red	gris/rouge	gris/rojo	grijs/rood	cinzento/vermelho	grigio/rosso	šedo/červený	szürke/piros	szaro/czerwony	γκρι/κόκκινο	grå/röd	siva/rdeča	gri/kırmızı
6		black/red	noir/rouge	negro/rojo	zwart/rood	preto/vermelho	nero/rosso	černo/červený	fekete/piros	czarno/czerwony	μαύρο/κόκκινο	svart/röd	črna/rdeča	siyah/kırmızı
7		grey/black	gris/noir	gris/negro	grijs/zwart	cinzento/preto	grigio/nero	šedo/černý	szürke/fekete	szaro/czarny	γκρι/μαύρο	grå/svart	siva/črna	gri/siyah
58b/2a		grey/white	gris/blanc	gris/blanco	grijs/wit	cinzento/branco	grigio/blanco	šedý/bílý	szürke/fehér	szaro/biały	γκρι/λευκό	grå/vit	siva/belaa	gri/beyaz
8		blue/red	bleu/rouge	azul/rojo	blauw/rood	azul/vermelho	blu/rosso	modro/červený	kék/piros	niebiesko/czerwony	μπλε/κόκκινο	blå/röd	modra/rdeča	mavi/kırmızı
9		red	rouge	rojo	rood	vermelho	rosso	červenno	piros	czerwony	κόκκινος	röd	rdeča	kırmızı
10		vacant	inutilisé	no ocupado	niet aangesloten	não ocupado	libero	neobsazen	nem foglalt	wolny	δεν είναι κατειλημμένος	ej anväänd	ni zasedeno	boş
11		vacant	inutilisé	no ocupado	niet aangesloten	não ocupado	libero	neobsazen	nem foglalt	wolny	δεν είναι κατειλημμένος	ej anväänd	ni zasedeno	boş
12		vacant	inutilisé	no ocupado	niet aangesloten	não ocupado	libero	neobsazen	nem foglalt	wolny	δεν είναι κατειλημμένος	ej anväänd	ni zasedeno	boş
13		brown	brun	marrón	bruin	castanho	marrone	hnědo	barna	brązowo	καφέ	brun	smeđa	kahverengi

24

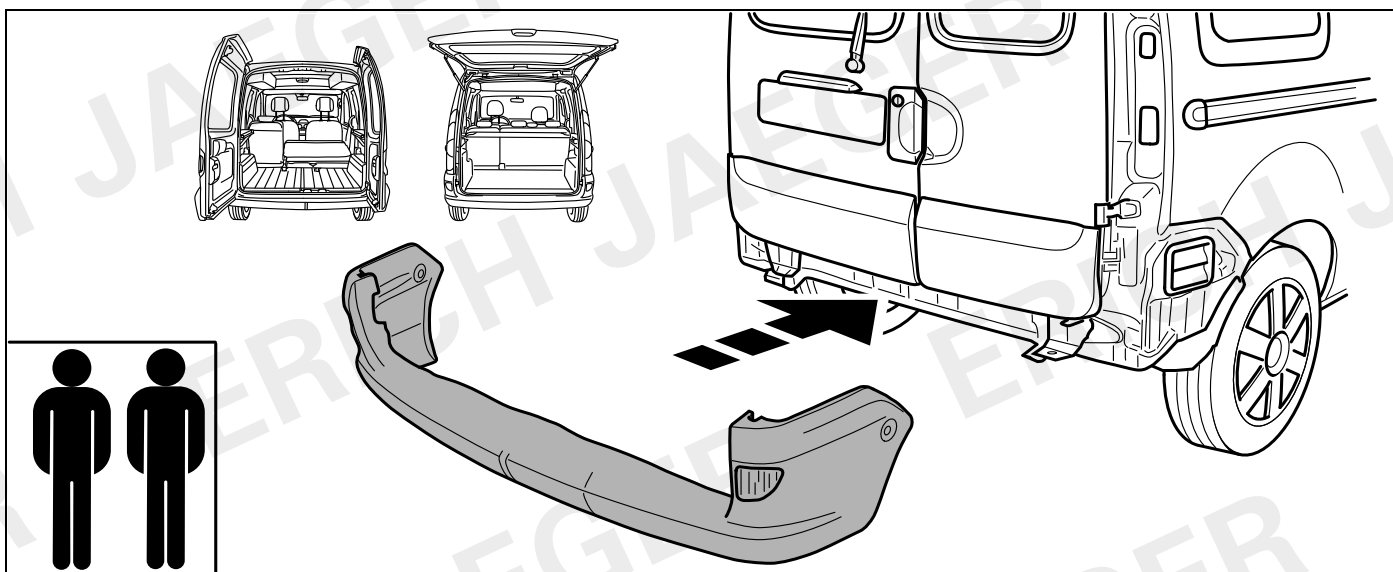

25

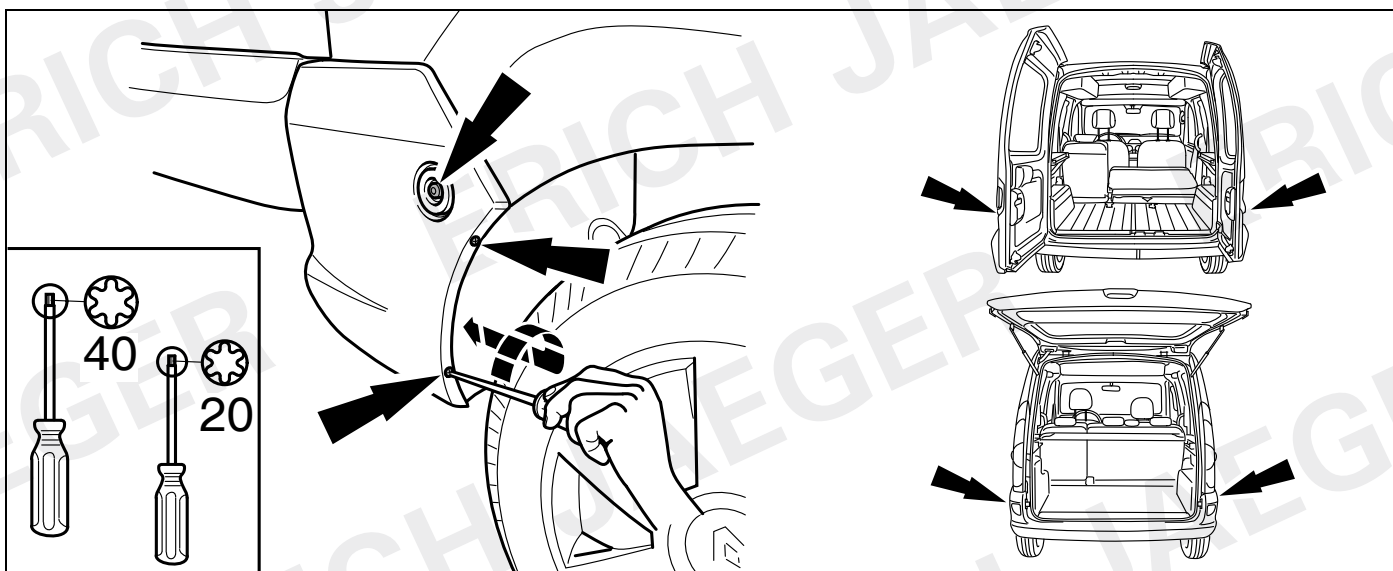

26

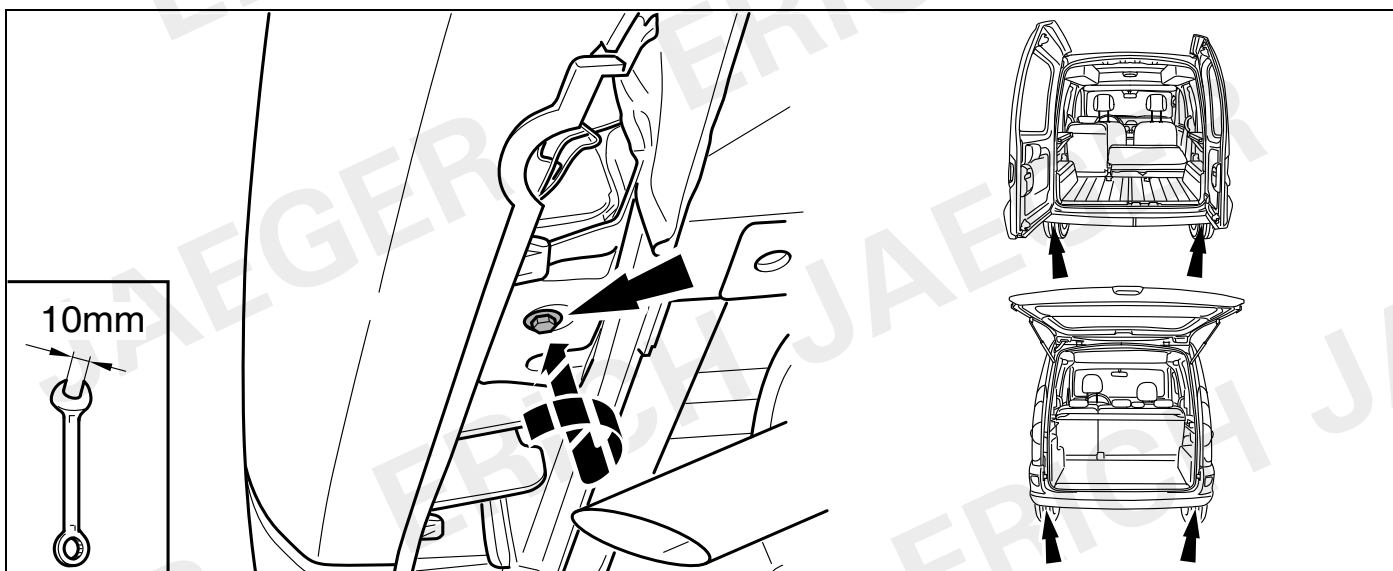

27

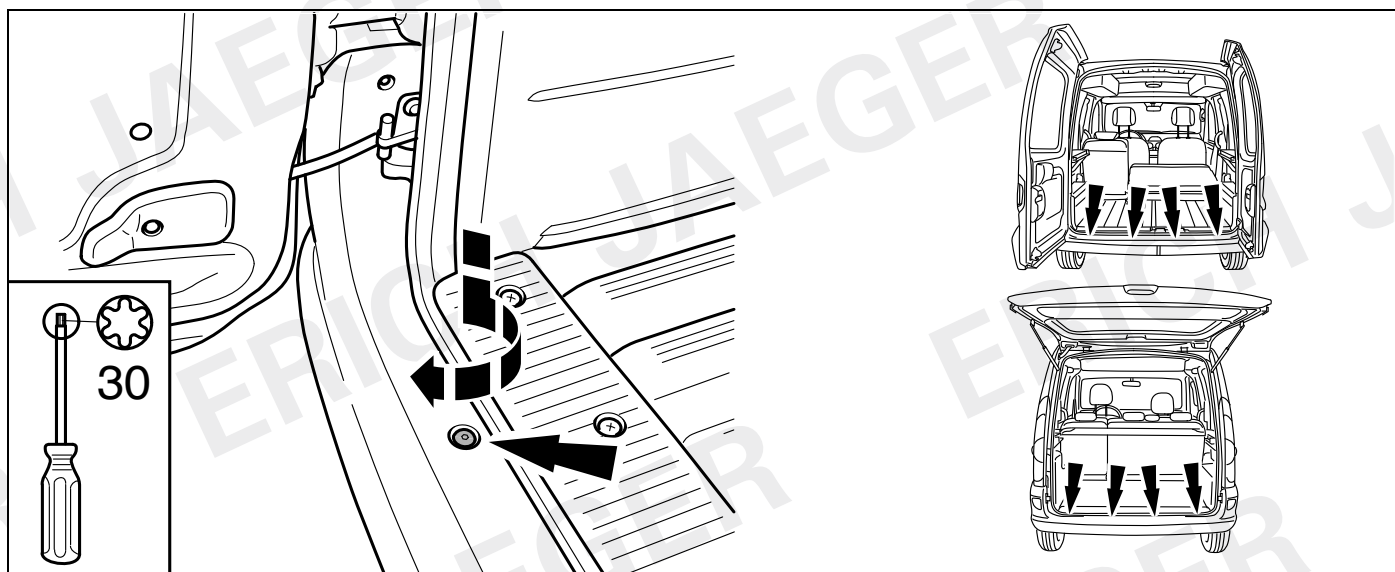

28

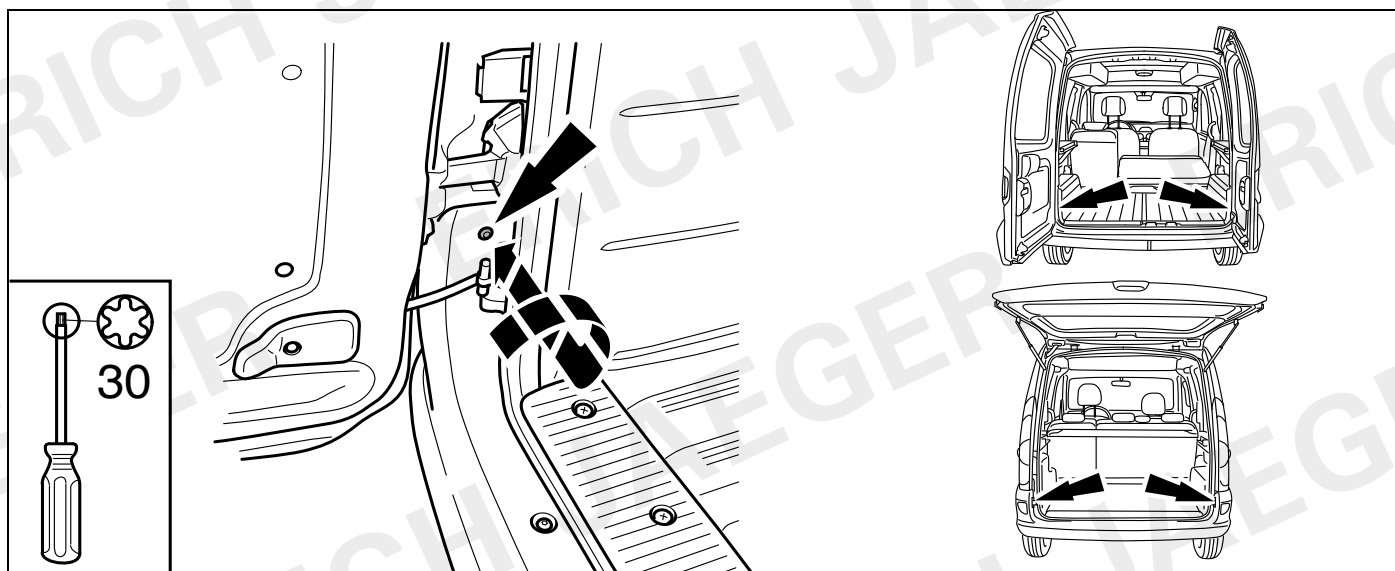

29

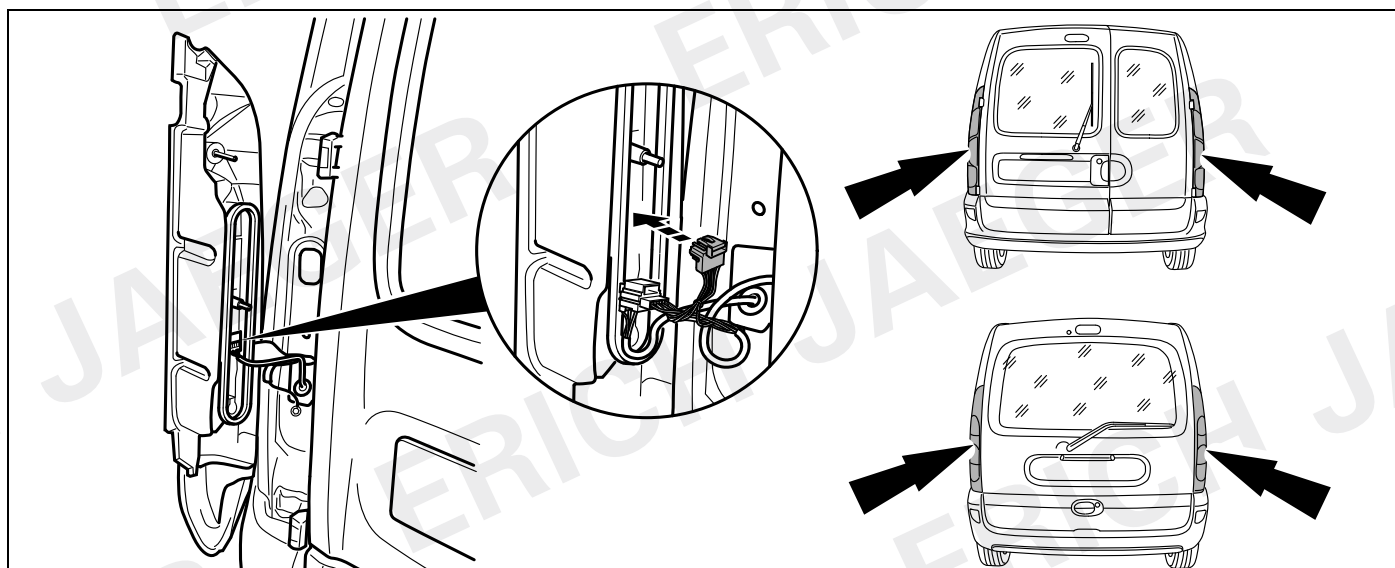

30

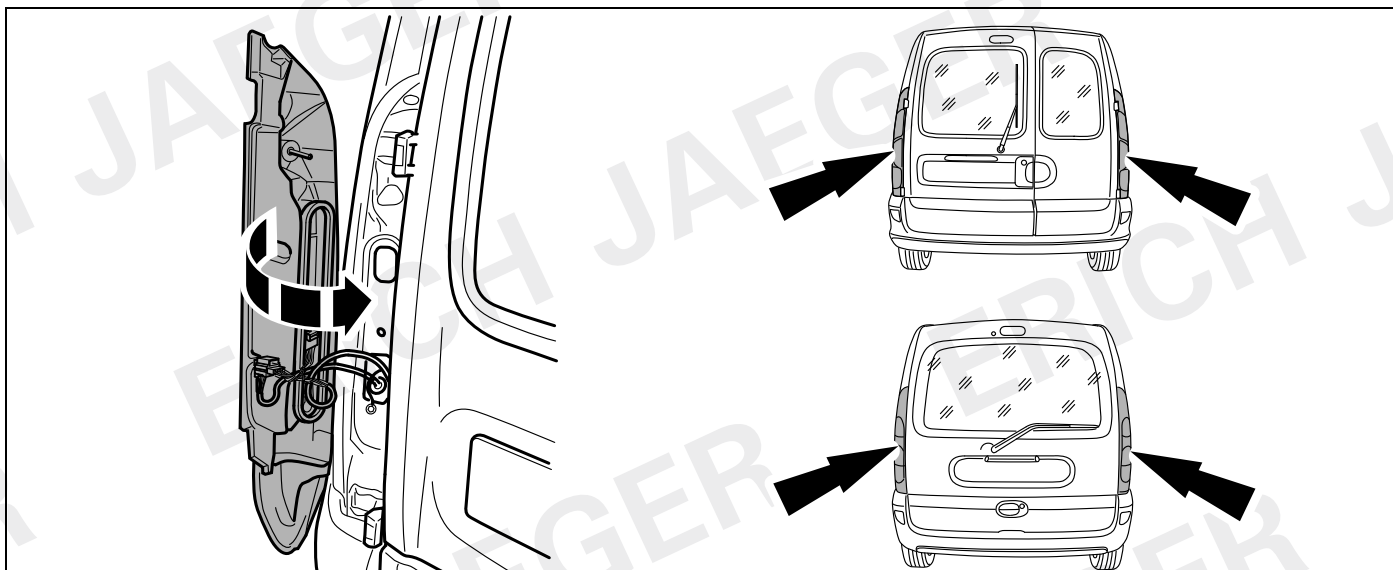

31

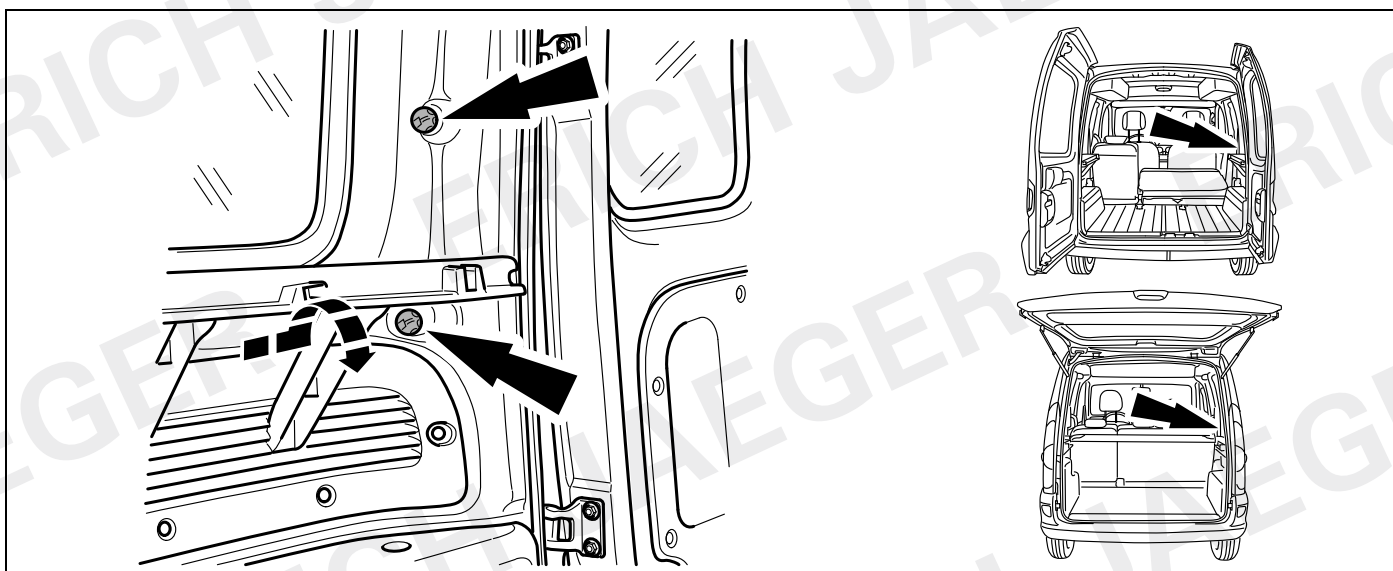

32

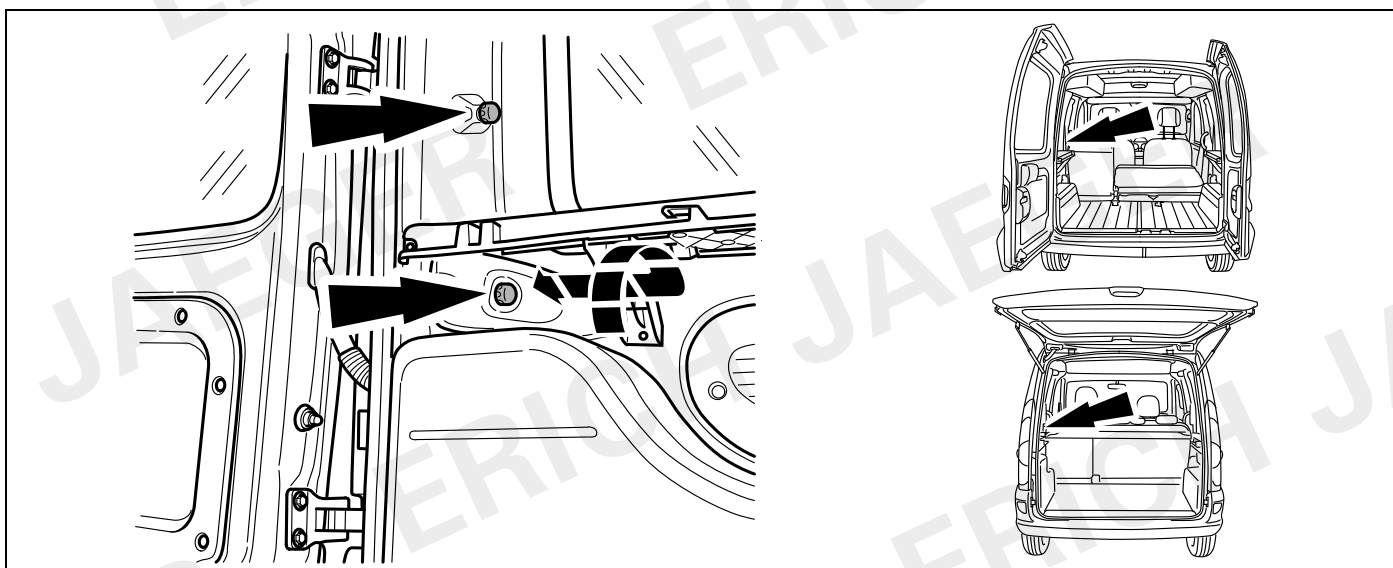

33

745008



ERICH JAEGER-Artikelnummer:
ERICH JAEGER part number:

721075

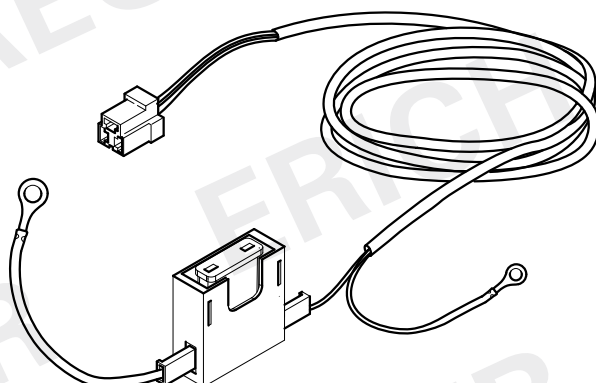
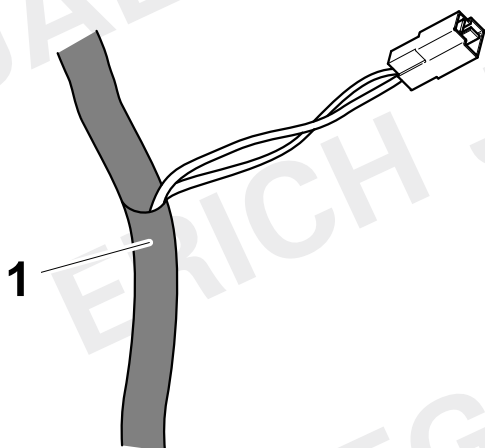

34

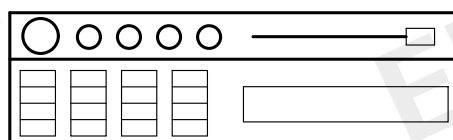
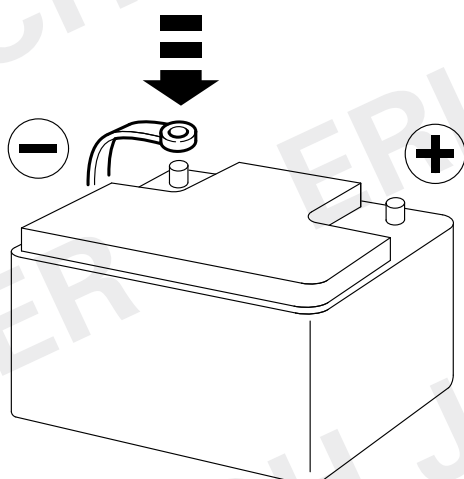

Radio Code

35

(D) Funktionen kontrollieren!

(GB) Check functions!

(F) Contrôler les fonctions!

(E) Compruebe las funciones!

(NL) Controleer functies!

(P) Verifique as funções!

(I) Controllare le funzioni!

(CZ) Zkontrolujte funkci!

(H) Ellenőrizze a funkciókat!

(PL) Sprawdź działanie!

(GR) Έλεγχος λειτουργίας!

(S) Kontrollera funktionerna!

(SLO) Preverite delovanje!

(TR) İşlevleri kontrol edin!

311069

311052

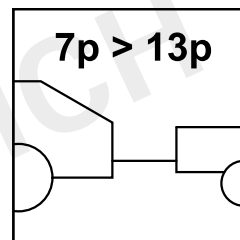
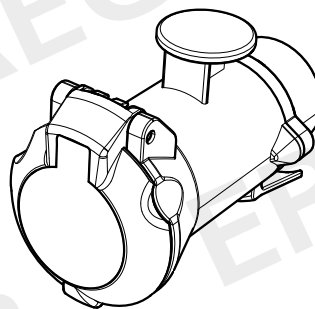
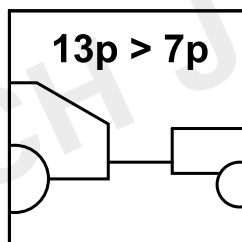
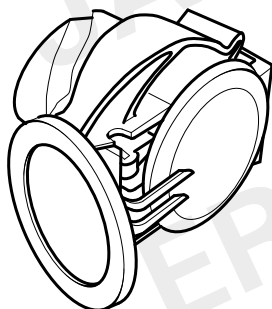

(D) Technische Änderungen vorbehalten!

(GB) Subject to change!

(F) Sous réserve de modifications techniques!

(E) Salvo modificaciones técnicas!

(NL) Technische wijzigingen voorbehouden!

(P) Sujeito a modificações técnicas!

(I) Salvo modificaciones técnicas!

(CZ) Technická práva vyhrazena!

(H) Műszaki módosítások joga fenntartva!

(PL) Zastrzegamy sobie możliwość wprowadzenia zmian technicznych!

(GR) ιατηρούμε το δικαίωμα των τεχνικών αλλαγών!

(S) Ändringar förbehålls!

(SLO) Pravice do sprememb pridržane!

(TR) Teknik değışiklikler mahfuzdur!